

| REV | LOCATIONS | DESCRIPTION | DATE | REVISER | APPD |
|-----|-----------|--------------------------------|-----------|---------|--------|
| 2 | | Structure and material changes | 18/JAN/22 | KATE | CHERRY |

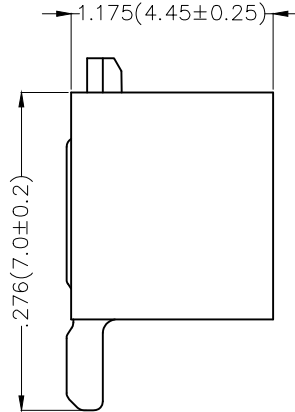
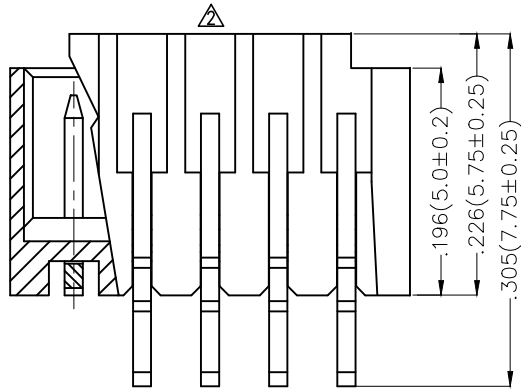
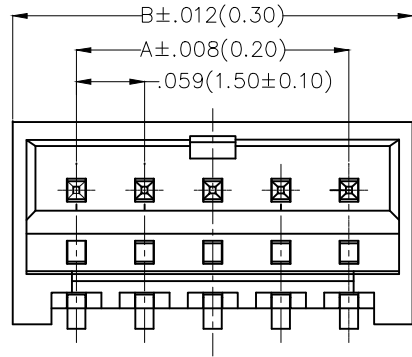

Electrical

Current Rating: 2.5A AC(rms)/DC
 Voltage Rating: 250V AC(rms)/DC
 Contact Resistance: 20 mΩ Max
 Insulation Resistance: 1000 MΩ MIN
 Withstanding Voltage: 500V AC r.m.s
 Temperature Range—Operating: -40°C~+105°C

Material and Plating

Housing: PA9T(UL 94V-0)
 Contact Pin: Phosphor bronze
 Plating: Tin Plated

Mates With(Housing): FHG15003 Series.

| Circuits (n) | Part No. | Dimensions(in/mm) | |
|--------------|--------------------|-------------------|-------------|
| | | A | B |
| 2 | FWF15008-S02B24W5M | .059(1.50) | .173(4.40) |
| 3 | FWF15008-S03B24W5M | .118(3.00) | .232(5.90) |
| 4 | FWF15008-S04B24W5M | .177(4.50) | .291(7.40) |
| 5 | FWF15008-S05B24W5M | .236(6.00) | .350(8.90) |
| 6 | FWF15008-S06B24W5M | .295(7.50) | .409(10.40) |
| 7 | FWF15008-S07B24W5M | .354(9.00) | .469(11.90) |
| 8 | FWF15008-S08B24W5M | .413(10.50) | .528(13.40) |
| 9 | FWF15008-S09B24W5M | .472(12.00) | .587(14.90) |
| 10 | FWF15008-S10B24W5M | .531(13.50) | .646(16.40) |
| 11 | FWF15008-S11B24W5M | .591(15.00) | .705(17.90) |
| 12 | FWF15008-S12B24W5M | .650(16.50) | .764(19.40) |
| 13 | FWF15008-S13B24W5M | .709(18.00) | .823(20.90) |
| 14 | FWF15008-S14B24W5M | .768(19.50) | .882(22.40) |
| 15 | FWF15008-S15B24W5M | .827(21.00) | .941(23.90) |

Ordering Information

FWF 150 08 - S XX B 2 4 W5 M
 1 2 3 4 5 6 7 8 9 10

| | | | | | |
|---------------------------|-----------------------------------|---------------------------|------------------------------|------------------|------------------------------|
| 1 Category FWF-Wafer | 2 Series Number 150-Pitch1.5mm | 3 Distinction No. 08 | 4 Row Option S-Single row | 5 Circuits XX | 6 Entry Angle B-90° Angle |
| 7 Plating 2-Tin Plated | 8 Material-Resin 4-PA9T | 9 Color-Resin W5-White | 10 Packaging M-Reel | | |

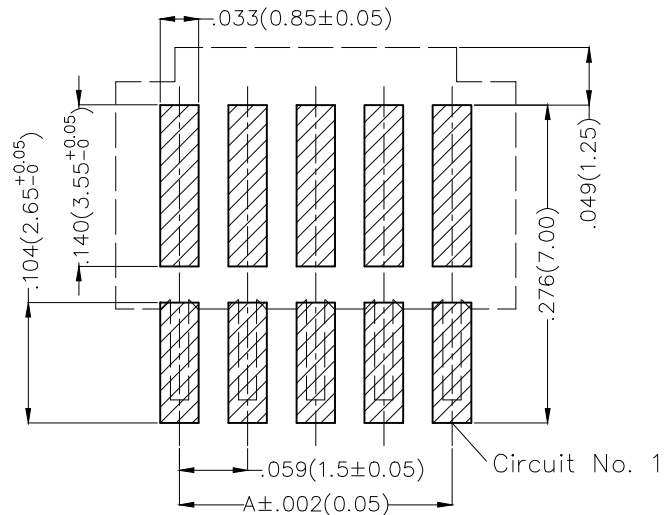

Recommended P.C.Board Layout

| | | | | | | | |
|--------------|---------------------------------------|--|--|---------------------|--|---|---------------------|
| | GENERAL TOLERANCES (UNLESS SPECIFIED) | | APPROVE BY FRANK | DATE 16/SEP/15 | PART NO. FWF15008-SXXB24W5M | ITEM NO. FWF15008 | |
| | DESIGN UNITS Inch (metric) | X.±.012(0.30) X.X±.008(0.20) X.XX±.006(0.15) X.XXX±.004(0.10) | X'±5" .X'±2" .XX'±1" .XXX'±0.5" | CHECKED BY JACOB | DATE 16/SEP/15 | TITLE Wire to Board (Wafer) Pitch 1.5mm 90° Angle (SMT) | |
| SCALE 5:1 | SIZE A4 | | DRAWN BY CHERRY | DATE 16/SEP/15 | THIS DRAWING CONTAINS INFORMATION THAT IS PROPRIETARY TO TXGA INDUSTRIAL ELECTRONICS(S.Z)CO.,LTD AND SHOULD NOT BE USED WITHOUT WRITTEN PERMISSION | | REV 2 SHEET NO. 1/1 |